

THE LANGHAM

LONDON

the
ART
of the
STAY



SUPERB LOCATION

The Langham, London has an unrivalled location in the heart of the West End on Regent Street, situated between London's most sought after 'villages' of Marylebone, Fitzrovia, Mayfair and Soho. With access to the bustling shops and restaurants of Regent Street and Bond Street, as well as the professional and residential communities of Marylebone and Fitzrovia, the hotel is the ideal destination for both leisure and business travellers alike.





TIMELESS ELEGANCE

The Langham, London opened in 1865 as Europe's first 'Grand Dame Hotel' and continues to welcome dignitaries, royalty and international elite throughout its reign. With 380 exquisitely appointed rooms, guests will enjoy genuine service reflecting the hallmarks of its rich heritage, always anticipating but never overbearing. The hotel has evolved over time and strongly adheres to corporate social responsibility in the twenty first century. The Langham, London has been awarded Gold status by Earthcheck, the world's leading scientific benchmarking certification for travel and tourism.



LUXURIOUS ACCOMMODATION

Relax in comfort and style in one of the 344 rooms and 36 elegantly furnished suites including The Sterling Suite, London's largest and most coveted retreat with up to six bedrooms, inspired by the sterling heritage of English pageantry and precious materials. All furniture within the suite is custom made with gold and silver leaf hand-painted finishes, exquisite marble and antique mirror work. Additional signature guestrooms and suites include The Wedgwood Suite, featuring bespoke Wedgwood furnishings and interiors, and the two bedroom Infinity Suite.





THE LANGHAM CLUB

Inspired by private clubs of the Victorian era, The Langham Club redefines the club concept with the ultimate in exclusivity, modern conveniences and attentive service. Offering a private sanctuary, The Langham Club features several distinct propositions from the point of arrival until departure, providing butler and specialist Concierge services in addition to private showers and changing facilities available for guests requiring early arrival and late departure. Complimentary services include the pressing of three items of clothing and two hours use of the Club's Loft meeting space.





EXQUISITE DINING

The hotel's unique partnership with legendary icons, father and son team Albert Roux and Michel Roux Jr., can be enjoyed in all the restaurant and bars, meetings and events and from the comfort of your own guestroom. Roux at The Landau entices with classically constructed dishes offering French cuisine with a British twist. The restaurant serves breakfast, lunch, dinner and the only Sunday brunch by Chez Roux. The restaurant's private dining room Postillion can accommodate up to 18 people.





WORLD'S BEST BAR

Guests will be inspired in Artesian, named after the original 360ft-deep well under the hotel, and bestowed with the coveted 'World's Best Bar' accolade, creating classic and innovative cocktails. Artesian's lunch menu is creative and elevates the bar food and drinks out of the ordinary and into the gourmet. In the evening guests may enjoy SNAX, a tapas-style concept, inspired by Artesian cocktails.



A TASTE OF TRADITION

The sparkling centrepiece of the hotel, Palm Court is famed as the birthplace of Afternoon Tea providing a sense of occasion against a backdrop of daily live music. Celebrate this timeless ritual with a selection of 30 tea blends, cakes, beautiful pastries, scrumptious scones and delicate finger sandwiches. The evening menu features original recipes and classic French dishes inspired by the Grand cafes of iconic Europe that will tempt you to a variety of dishes, ideal for indulgent evenings or early bites.



SUCCESSFUL MEETINGS

From industry conferences to social events, the hotel provides a venue for all occasions. An attentive events team can accommodate every request, coupled with dining options by Chez Roux. From intimate gatherings in the Lower Carriage Rooms, the state-of-the-art meeting rooms, to extravagant banquets held in the glamorous Grand Ballroom, The Langham, London is the ideal setting. With 'Private Dining by Roux', guests will enjoy a unique dining concept providing the hallmarks of classic French cuisine with a modern twist.



ROOM CAPACITIES AND PLANS

ROOM	CAPACITIES												DIMENSIONS			
	Boardroom	Classroom (with BP)	Theatre (with BP)	Hollow Square (with BP)	U-Shape (with BP)	Cabaret (with BP)	Reception	Dinner Seated	Dinner Dance	Seated Buffet	Standing Buffet	Length m (ft)	Width m (ft)	Height m (ft)	Area sqm (sqft)	
The Grand Ballroom	80	144 (120)	250 (250)	90 (N/A)	83 (63)	160 (136)	375	250	200	200	300	30.2 (99)	12.1 (39.6)	6.04 (19.8)	360 (3875)	
The Portland Foyer	46	60 (N/A)	110 (N/A)	50 (N/A)	45 (N/A)	56 (N/A)	200	120	N/A	120	180	20.5 (67.3)	13 (42.6)	2.23 (7.3)	266 (2863)	
The Courtyard Garden*	N/A	N/A	N/A	N/A	N/A	N/A	250	160	N/A	150	200	20.9 (68.7)	17.6 (57.9)	N/A	420 (4521)	
Postillion	N/A	N/A	N/A	N/A	N/A	N/A	35	18	N/A	N/A	N/A	7.7 (25.3)	5 (16.4)	5.18 (17)	39 (420)	
The Conservatory	30	34 (N/A)	42 (N/A)	28 (N/A)	24 (N/A)	30 (N/A)	50	30	N/A	30	40	10.25 (33.7)	4.1 (13.5)	2.4 (7.1)	42 (452)	
The Mayfair	16	N/A	N/A	N/A	N/A	N/A	N/A	N/A	N/A	16	N/A	7.92 (26)	6.4 (21)	4.27 (14)	51 (549)	
The Marylebone	20	30 (N/A)	70 (N/A)	30 (N/A)	19 (N/A)	40 (N/A)	70	N/A	N/A	50	70	7.92 (26)	9.75 (32)	2.62 (8.6)	83 (893)	
The Marylebone I	12	15 (N/A)	30 (N/A)	N/A	12 (N/A)	16 (N/A)	30	N/A	N/A	20	25	7.92 (26)	5.79 (19)	2.62 (8.6)	46 (495)	
The Marylebone II	12	15 (N/A)	20 (N/A)	N/A	12 (N/A)	16 (N/A)	25	N/A	N/A	20	25	7.92 (26)	5.57 (15)	2.62 (8.6)	37 (398)	
The Soho	10	N/A	N/A	N/A	N/A	N/A	N/A	N/A	N/A	10	N/A	5.49 (18)	3.66 (12)	2.5 (8.2)	20 (215)	
The Fitzrovia	30	42 (N/A)	77 (N/A)	38 (N/A)	34 (N/A)	48 (N/A)	80	N/A	N/A	60	80	14.3 (47)	5.79 (19)	2.62 (8.6)	82 (883)	
The Fitzrovia I	18	20 (N/A)	49 (N/A)	26	21 (N/A)	24 (N/A)	40	N/A	N/A	30	40	8.23 (27)	5.79 (19)	2.62 (8.6)	48 (517)	
The Fitzrovia II	10	12 (N/A)	24 (N/A)	N/A	12 (N/A)	12 (N/A)	20	N/A	N/A	10	15	6.1 (20)	5.79 (19)	2.62 (8.6)	35 (377)	
The Stanhope	8	N/A	8 (N/A)	N/A	N/A	N/A	10	8	N/A	6	8	4.75 (15.6)	4.02 (13.2)	2.41 (7.9)	18 (194)	
The Surrey	22	30 (N/A)	50 (N/A)	24	18 (N/A)	28 (N/A)	50	40	N/A	30	40	7.92 (26)	7.62 (25)	2.41 (7.9)	61 (656)	
The Stanhope and The Surrey	N/A	N/A	N/A	N/A	N/A	N/A	N/A	N/A	N/A	40	50					
The Brougham	10	N/A	12 (N/A)	N/A	12 (N/A)	N/A	12	8	N/A	8	10	4.6 (15.1)	4.6 (15.1)	2.41 (7.9)	21 (226)	
The Barouche	20	30 (N/A)	50 (N/A)	16	14 (N/A)	28 (N/A)	50	40	N/A	30	40	8.05 (26.4)	7.53 (24.7)	2.41 (7.9)	61 (657)	
The Brougham and The Barouche	N/A	N/A	N/A	N/A	N/A	N/A	N/A	N/A	N/A	40	52					
The Phaeton	16	24 (N/A)	50 (N/A)	16	14 (N/A)	24 (N/A)	50	36	N/A	30	40	7.77 (25.5)	7.04 (23.1)	2.41 (7.9)	52 (560)	
The Clarence	6	N/A	N/A	N/A	N/A	N/A	N/A	6	N/A	6	N/A	4.51 (14.8)	4.51 (14.8)	2.41 (7.9)	20 (215)	
The Victoria	16	18 (N/A)	30 (N/A)	16	14 (N/A)	21 (N/A)	40	30	N/A	20	30	5.82 (19.1)	7.53 (24.7)	2.41 (7.9)	44 (474)	

*Sold only in conjunction with The Grand Ballroom BP – Back Projection

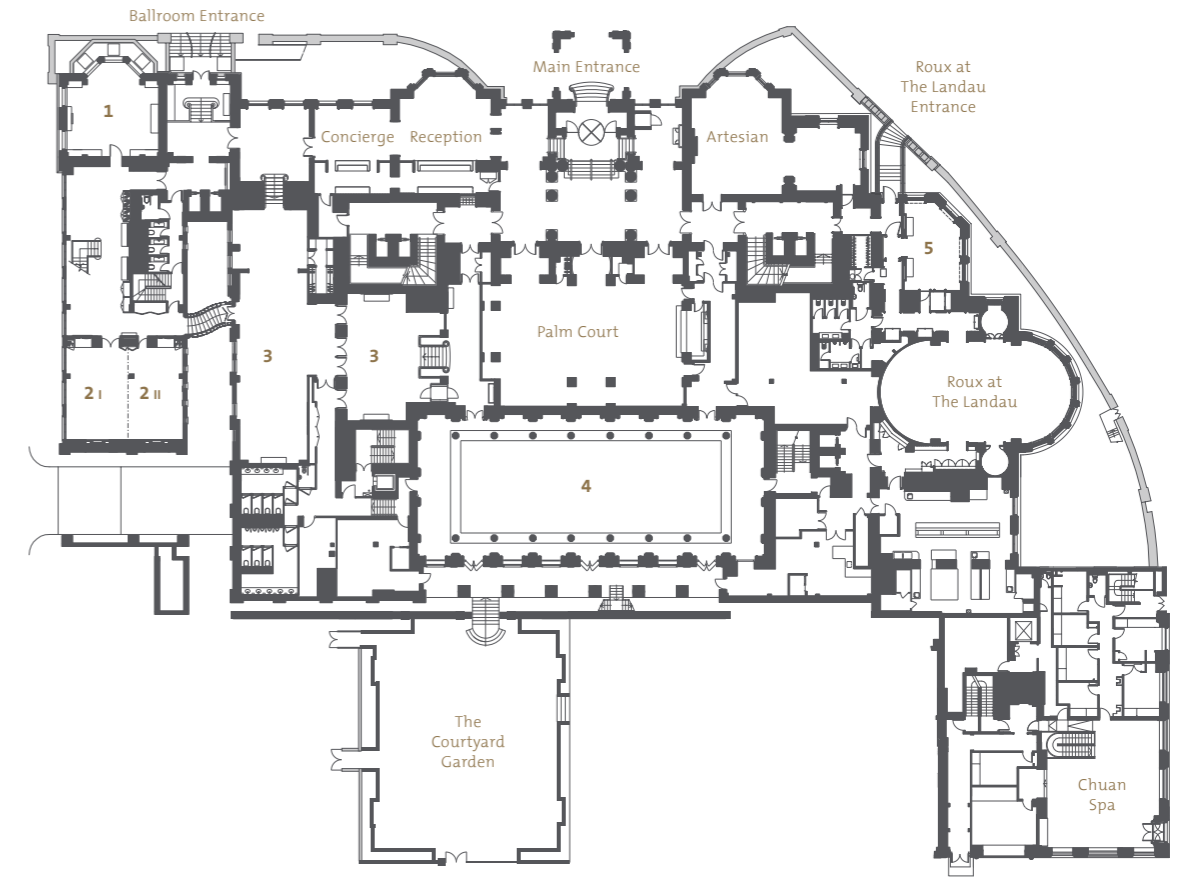

- 1 The Mayfair
- 2 The Marylebone I and II
- 3 The Portland Foyer
- 4 The Grand Ballroom
- 5 Postillion
- 6 The Soho
- 7 The Fitzrovia I and II
- 8 The Victoria
- 9 The Brougham
- 10 The Barouche
- 11 The Stanhope
- 12 The Surrey
- 13 The Clarence
- 14 The Phaeton



MEMORABLE EVENTS

From the Lower Carriage Rooms to the lavish Grand Ballroom and adjoining Courtyard Garden, the hotel provides a setting for every memorable event. At The Langham, London, unforgettable occasions from intimate dinners to extravagant soirées, will be enjoyed and talked about for years to come. The hotel has welcomed high society and social occasions since opening its doors in 1865 and continues to create lasting impressions with its unique menus by legendary icons Albert Roux and Michel Roux Jr. A dedicated team of event specialists will tailor all types of events to ensure your vision is met.





HEALTH AND FITNESS

Chuan Spa offers a luxury haven in the heart of London with a philosophy steeped in the values of Traditional Chinese Medicine. Guests can enjoy the ultimate in relaxation through a bespoke holistic journey with therapies designed to rebalance and revitalise the body and soul. Chuan Spa has six private treatment rooms, a vitality pool, herbal steam rooms and saunas. Lifestyle facilities include a fully equipped fitness centre with state-of-the-art Technogym cardio and resistance equipment, free weights and a 16-metre swimming pool.



Central LONDON

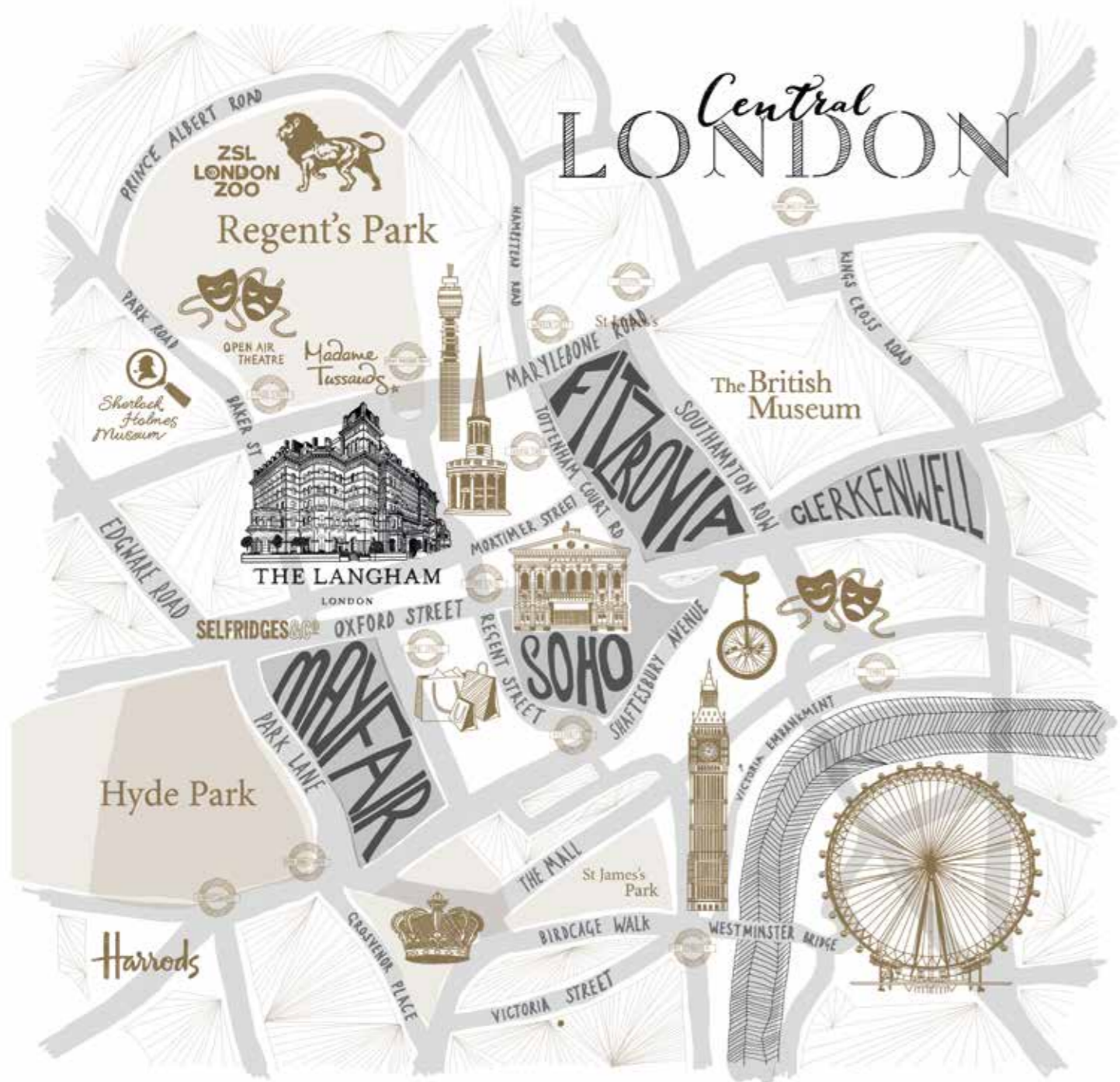

The Langham, London
1c Portland Place, Regent Street, London W1B 1JA T 44 (20) 7636 1000 F 44 (20) 7323 2340 tlon.info@langhamhotels.com
langhamhotels.com/london